



Nova Southeastern University, Rolling Hills Conference Center Davie, Florida

Gallo Herbert Lebolo

Client:

Nova Southeastern University; John Santulli, Vice President of Facilities Management

Total area:

39,124 sq. ft.

Total cost:

\$7 million (estimate)

Total cost/square foot:

\$179

Completion:

March 2011

Photographers:

Artek Rendering and Design Studio (rendering)/Dario and Nicolas Huarte, artists; Santayana Design Inc. (sketch)/ Glen Santayana, artist



Rendering



Main entry sketch

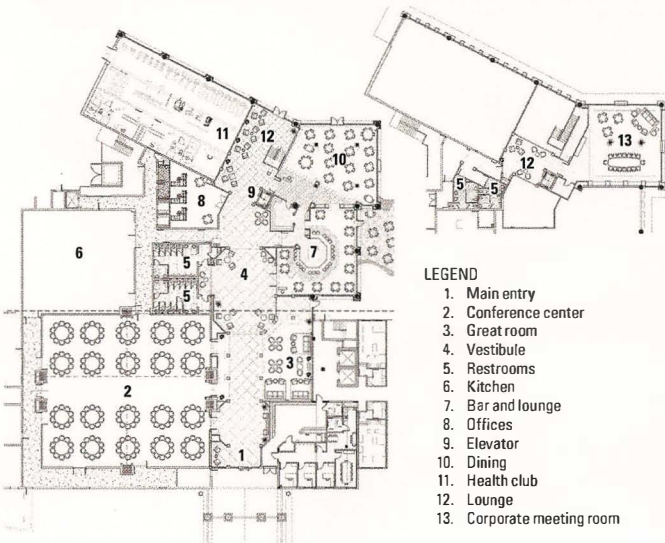

- LEGEND
- 1. Main entry
 - 2. Conference center
 - 3. Great room
 - 4. Vestibule
 - 5. Restrooms
 - 6. Kitchen
 - 7. Bar and lounge
 - 8. Offices
 - 9. Elevator
 - 10. Dining
 - 11. Health club
 - 12. Lounge
 - 13. Corporate meeting room

Nova Southeastern University (NSU), with 28,000 students, needed a conference center to support campus and community events. Large events were being outsourced to off-campus venues, and the architect was commissioned to bring these programs on-campus.

The university decided to renovate one of three buildings at the old site of Rolling Hills Country Club, with the additional two previously renovated by the architect into graduate housing. The firm themed the renovation in a contemporary rendition of an elegant antebellum mansion that would reflect the grandiose, southern country-club tradition of the adjacent golf resort owned by NSU.

The Rolling Hills Conference Center will serve as a venue for entertaining visiting professors, and for symposiums and lectures. The community will be able to take advantage of the state-of-the-art conference center, as it will be available for weddings, meetings and similar events. The facility design features rich wood finishes, warm and inviting color schemes, marble flooring, rich fabrics and furniture that blend southern comfort with contemporary design.



Main entry rendering